

N.A.D./Soroptimist Park

Legend

- rootstock, big tree
- earth bank
- uncrossable cliff
- boulder, stump
- building, ruin
- manmade object
- out of bounds area
- stream, intermittent stream
- narrow marsh or trickle
- marsh, less distinct marsh
- open forest
- slow running: good/poor visibility
- difficult to run: good/poor visibility
- difficult to walk
- clearing or lawn
- rough open land, rough open land with scattered trees
- paved road, parking area
- dirt road or vehicle track
- large and small trails
- faint or intermittent trail
- ride or old road grade
- high and low fences
- contour, index contour
- form line (tags point downhill)
- knolls
- depression
- disc golf hole

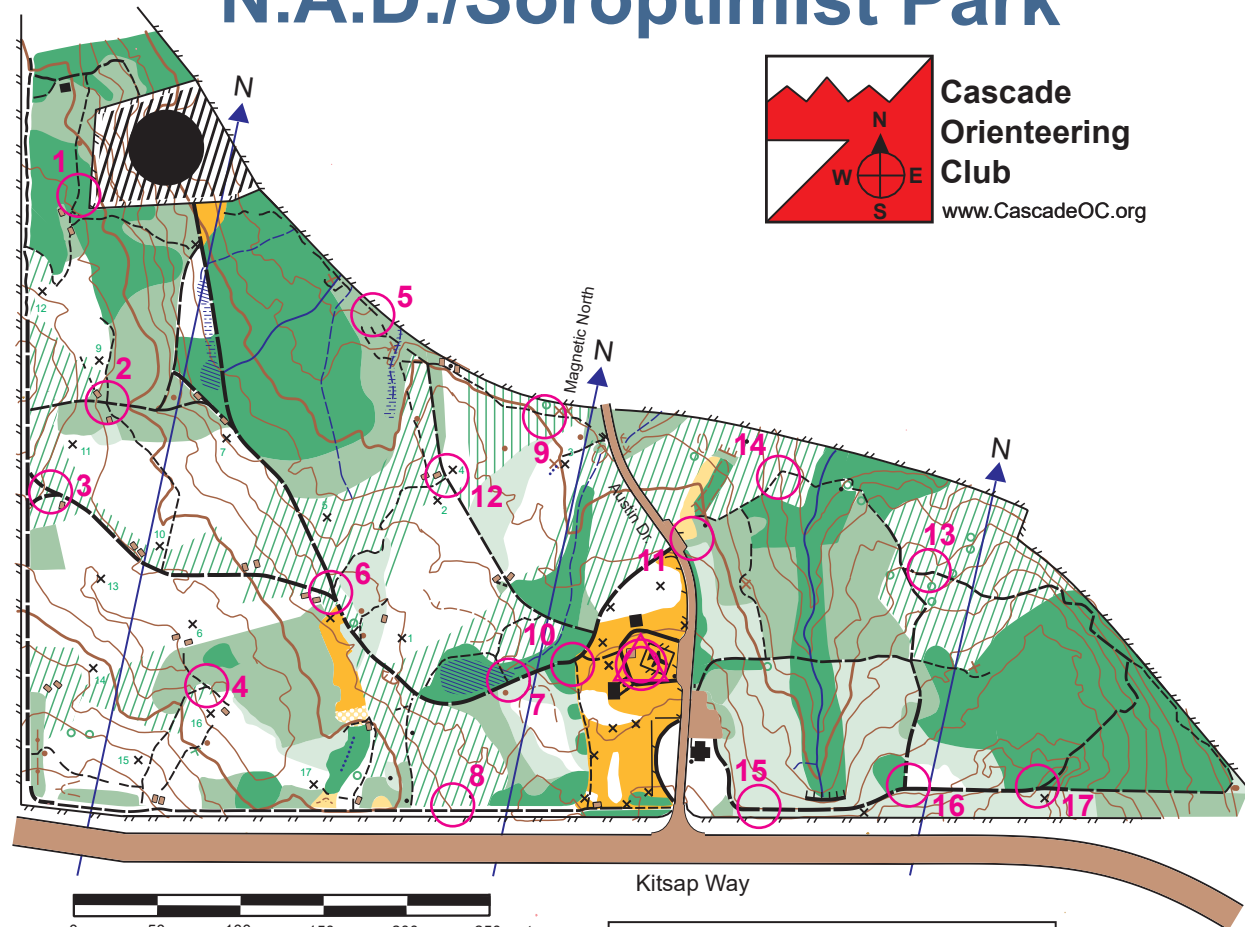

This map is limited to personal non-commercial use. If you wish to use this map for a group activity or to resell this map for any purpose, please obtain Permission from Cascade Orienteering Club (info@cascadeoc.org). Please follow all applicable land use rules and stay out of the private property and other forbidden areas indicated on this map.



scale 1:5000 - contour interval 3 meters

Version: Oct16

©2016 Cascade Orienteering Club

Base Map.....Sean Olmstead and Mike Schuh--Nov 1988
 Fieldwork.....Jim Sisco--Oct 2016
 Cartography.....Debbie Newell--1989, Jim Sisco--Oct 2016

Permanent Orienteering Course Designed and Installed by Owen Biesel, Troop 1567, for his Eagle Award Project--2005